



ARCHITECTURE | DESIGN | CONSTRUCTION  
 15810 PARK TEN PLACE, SUITE 300  
 HOUSTON, TEXAS 77084  
 713-465-4650  
 www.sligroup.com

HARRIS COUNTY ESD 48  
 ADMINISTRATION BUILDING RENOVATION  
 21201 MORTON ROAD  
 KATY, TEXAS 77499



Project Number : 8869

### KEYED NOTES

#	KEYNOTE
1	NO WORK IN THIS AREA. EXISTING ELECTRICAL LIGHTING TO REMAIN.

- ELECTRICAL LIGHTING PLAN GENERAL NOTES**
- A. ALL LIGHT FIXTURE LOCATIONS ARE APPROXIMATE. FOR EXACT LOCATION REFER TO ARCHITECTURAL DRAWINGS.
  - B. ALL OCCUPANCY SENSORS SHALL PROVIDE FULL ROOM COVERAGE. PROVIDE POWER PACKS AND OVERRIDE SWITCHES AS REQUIRED FOR CONTROL INDICATED.
  - C. ALL CEILING MOUNTED DEVICES LOCATED IN LAY-IN CEILINGS SHALL BE CENTERED IN THE CEILING TILE.
  - D. MULTIPLE SWITCHES SHOWN TOGETHER SHALL BE GANGED TOGETHER UNDER A COMMON COVER PLATE.
  - E. PROVIDE UNSWITCHED CIRCUIT TO ALL EXIT SIGNS AS INDICATED.
  - F. CONTRACTOR SHALL INDICATE LIGHTING CIRCUIT CONTROLLED BY EACH SWITCH BY PROVIDING TYPE WRITTEN LABELING LOCATED ON INSIDE FACE OF EACH SWITCH COVER PLATE.
  - G. FIXTURES DESIGNATED "NL" SHALL BE UNSWITCHED NIGHTLIGHT.
  - H. EMERGENCY CIRCUITS SHALL BE ROUTED IN SEPARATE CONDUIT FOR EMERGENCY LIGHTING.
  - I. PROVIDE ALL EMERGENCY LIGHT FIXTURES WITH UNSWITCHED HOT LEG AS DEFINED IN NEC 700.12
  - J. ALL EXTERIOR LIGHT TO BE CONTROLLED THRU LIGHTING CONTROLS (RELAY PANEL)
  - K. LIGHT FIXTURES DESIGNATED WITH "NL" SHALL BE NIGHT LIGHTS AND SHALL REMAIN ILLUMINATED 24 HOURS PER DAY, 7 DAYS PER WEEK.
  - L. C. ROUTE AN UNSWITCHED HOT LEG TO ALL "NL" FIXTURES FROM THE CIRCUIT SERVING THAT LIGHT FIXTURE.
  - M. EMERGENCY EGRESS LIGHTING PROVIDED VIA EMERGENCY GENERATOR WIRED TO ENTIRE BUILDING LIGHTING

### LIGHTING CONTROL LEGEND

	CEILING MOUNTED OCCUPANT SENSOR. PROVIDE FULL ROOM COVERAGE. CONNECT LIGHT FIXTURES SERVING ROOM THROUGH NEW SENSOR(S). AUTO OFF / AUTO ON.
	WALL MOUNTED OCCUPANT SENSOR. PROVIDE FULL ROOM COVERAGE. CONNECT LIGHT FIXTURES SERVING ROOM THROUGH NEW SENSOR(S). AUTO OFF / AUTO ON.
	CEILING MOUNTED VACANCY SENSOR. PROVIDE FULL ROOM COVERAGE. CONNECT LIGHT FIXTURES SERVING ROOM THROUGH NEW SENSOR(S). LIGHTS MUST BE TURNED ON MANUALLY (OR OPTIONALLY CAN BE CONFIGURED TO COME ON AUTOMATICALLY TO 50%).
	LIGHTING CONTROL POWER PACK.
	LOW VOLTAGE SWITCH(S) (0-10V DIMMER).
	WALL MOUNTED OCCUPANT SENSOR WITH 0-10V DIMMER. PROVIDE FULL ROOM COVERAGE. CONNECT LIGHT FIXTURES SERVING ROOM THROUGH NEW SENSOR(S). LIGHTS MUST BE TURNED ON MANUALLY (OR OPTIONALLY CAN BE CONFIGURED TO COME ON AUTOMATICALLY TO 50%).
	WALL MOUNTED OCCUPANT SENSOR WITH 0-10V DIMMER. PROVIDE FULL ROOM COVERAGE. CONNECT LIGHT FIXTURES SERVING ROOM THROUGH NEW SENSOR(S). AUTO OFF / AUTO ON.
	LINE VOLTAGE SWITCH

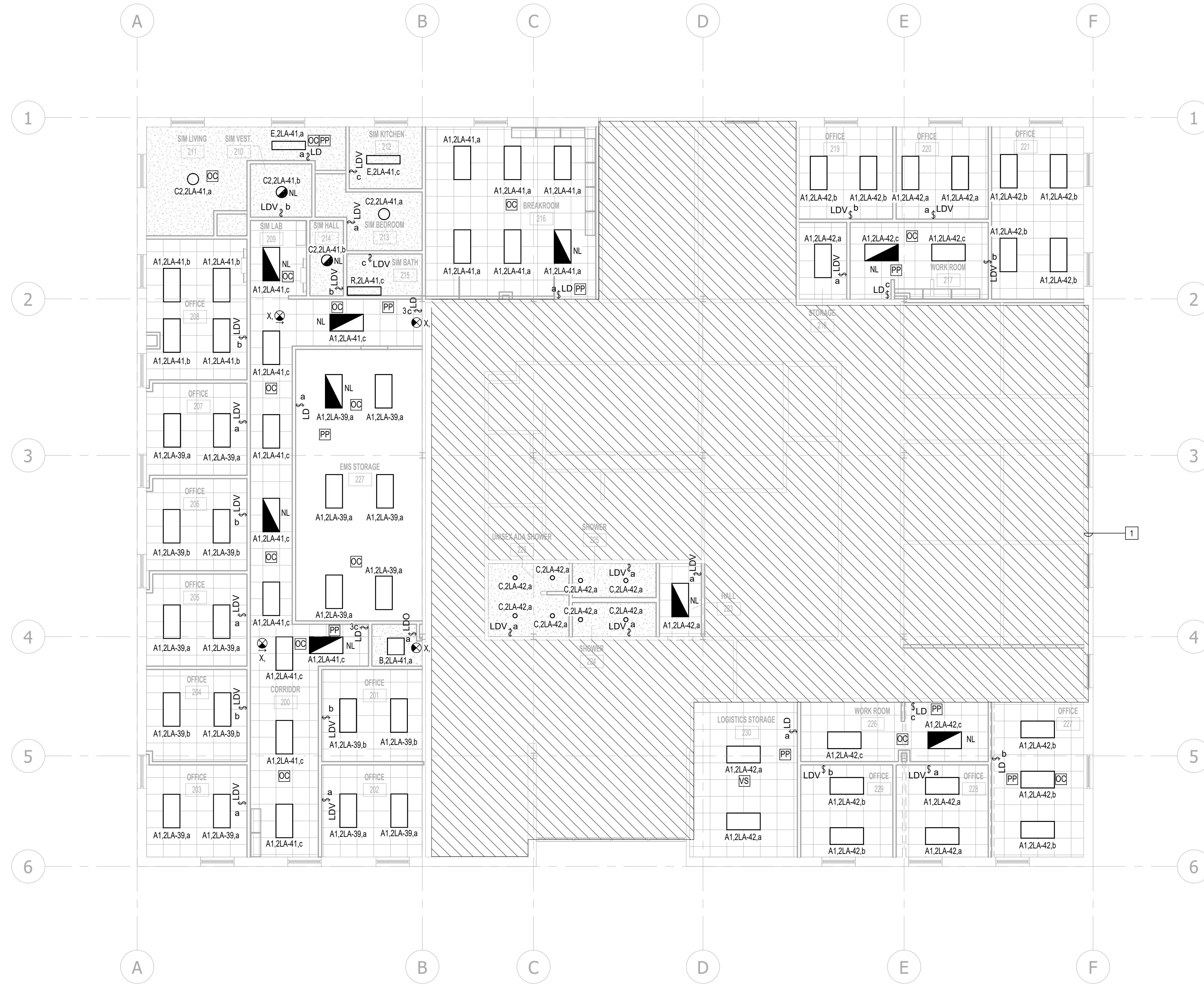

## 1 ELECTRICAL LIGHTING PLAN - LEVEL 2

1/8" = 1'-0"

JE#5120  
 02/09/2026  
 THE SEAL APPEARING ON THIS DOCUMENT WAS AUTHORIZED BY N. CURTIS JONES, JR., P.E. 58428

**JONES ENGINEERS, L.P.**  
 Consulting Mechanical/Electrical/Plumbing Engineers  
 9820 Whitthorn Dr. Houston, Texas 77095 (713)222-7766  
 Texas Registered Engineering Firm #F-3811

PRINT DATE: 2/11/2026 4:56:36 PM

DRAWING TITLE  
**ELECTRICAL LIGHTING PLAN - LEVEL 2**

DRAWN BY	JE	SHEET NO.
CHECKED BY	JE	<b>EL1.02</b>
APPROVED BY	JE	

C:\Users\patrick.thompson\AppData\Local\Autodesk\Revit\2026\Collaboration\Custom\21201MORTON\21201MORTON\21201MORTON.rvt