

SHELL FEDERAL CREDIT UNION KATY FULSHEAR 26620 FM 1093 KATY, TEXAS 77494

FLOODPLAIN INFORMATION

ACCORDING TO THE FEDERAL EMERGENCY MANAGEMENT AGENCY (FEMA), FLOOD INSURANCE RATE MAP (FIRM) FOR FORT BEND COUNTY, TEXAS, MAP NO. 48157C0105L REVISED/DATED APRIL 2, 2014, THE SUBJECT TRACT APPEARS TO LIE WITHIN UNSHADED ZONE "X".

BENCHMARK NOTES

BENCHMARK: HARRIS COUNTY FLOODPLAIN REFERENCE MARK RM NO. 190045 BEING A BRASS DISC STAMPED "190045" LOCATED ON A BRIDGE OVER BUFFALO BAYOU, APPROXIMATELY .5 MILES WEST FROM THE INTERSECTION OF CINCO RANCH BOULEVARD AND WESTHEIMER PARKWAY, PUBLISHED ELEVATION - 115.25.

TBM 3: BEING A BOX CUT ON THE BACK OF A CURB LOCATED FROM THE INTERSECTION OF THE SOUTHBOUND LANES OF WESTHEIMER LAKES NORTH DRIVE AND FARM TO MARKET 1093 ROAD, TRAVEL SOUTHWEST ON FARM TO MARKET 1093 ROAD APPROXIMATELY 1090 FEET, THEN TRAVEL 295 FEET NORTH TO THE SOUTH RIGHT-OF-WAY LINE OF PARK ROW, TO A BOX CUT ON THE BACK OF A CURB JUST NORTH OF THE TACO BELL, ELEVATION - 131.46.

TBM 4: BEING A BOX CUT ON THE BACK OF A CURB LOCATED FROM THE INTERSECTION OF THE SOUTHBOUND LANES OF WESTHEIMER LAKES NORTH DRIVE AND FARM TO MARKET 1093 ROAD, TRAVEL SOUTHWEST ON FARM TO MARKET 1093 ROAD APPROXIMATELY 930 FEET TO A PRIVATE DRIVEWAY, THEN TRAVEL 970 FEET NORTH TO THE BACK OF A CURB OF A CONCRETE MEDIAN, NORTHWEST OF THE XSCAPE MOVIE THEATER, ELEVATION - 132.33.

TBM "AAA": BEING A BOX CUT ON SET ON TOP OF A CONCRETE INLET LOCATED APPROXIMATELY 340 FEET NORTH FROM THE NORTH R.O.W. LINE OF FARM TO MARKET 1093 ROAD, AND 340 FEET EAST FROM THE EAST R.O.W. LINE OF RING ROAD. (SHOWN HEREON), ELEVATION - 132.34.

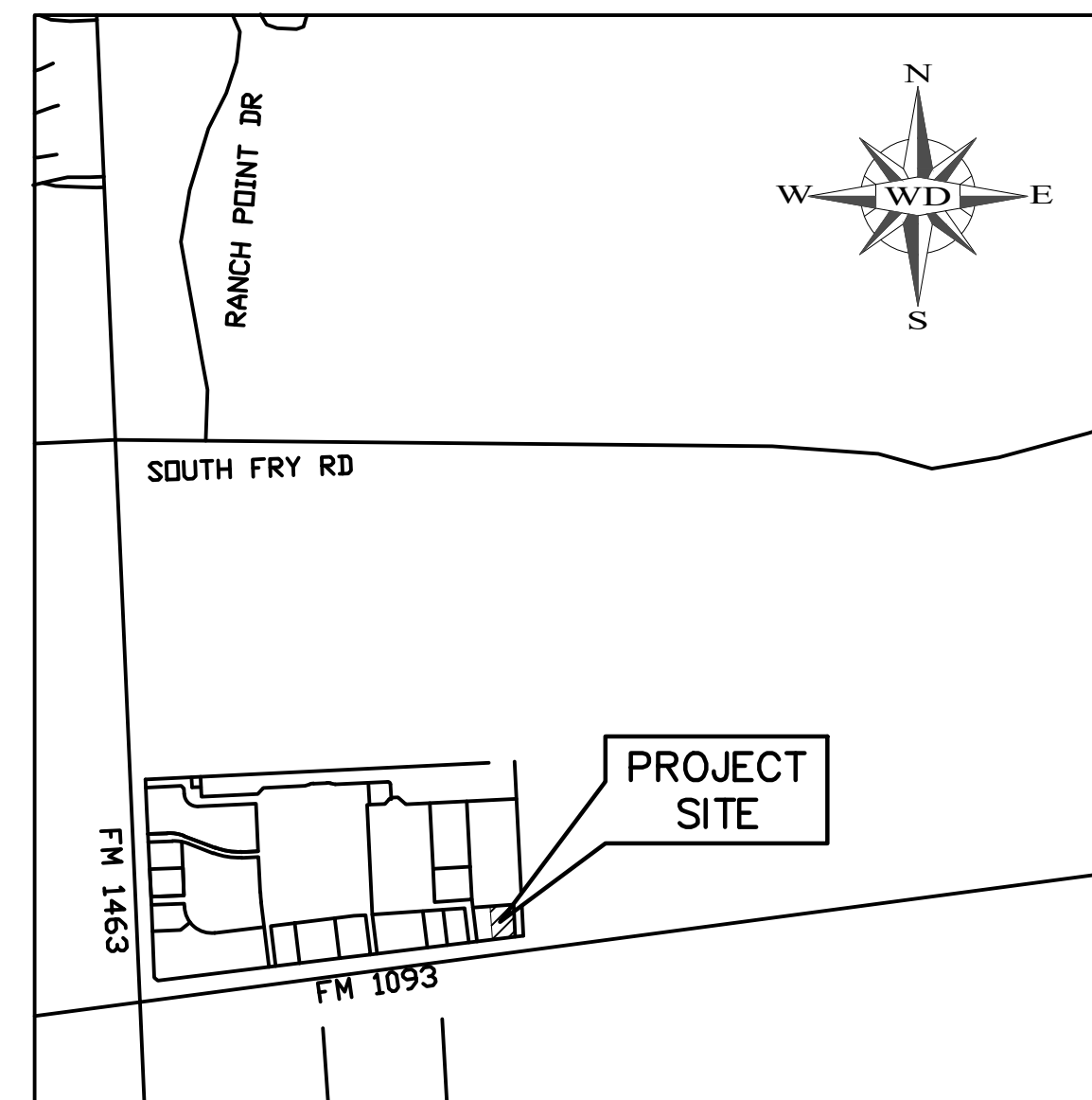

VICINITY MAP
CITY OF RICHMOND, FORT BEND COUNTY, TEXAS

INDEX OF DRAWINGS

- C1.00 COVER SHEET
- C1.01 GENERAL NOTES
- C1.02 PAVING, GRADING, AND UTILITY PLAN
- C1.03 DRAINAGE AREA MAP AND CALCULATIONS
- C1.04 STORM WATER POLLUTION PREVENTION PLAN
- C1.05 STORM WATER POLLUTION PREVENTION PLAN DETAILS
- C1.06 MISCELLANEOUS DETAILS
- C1.07 WATER, STORM, AND SANITARY DETAILS
- C1.08 FORT BEND CONCRETE PAVEMENT DETAILS
- C1.09 FORT BEND STORM SEWER CONSTRUCTION DETAILS



ARCHITECTURE • PLANNING • INTERIOR DESIGN
10200 OLD KATY ROAD
HOUSTON, TEXAS 77043
713-465-4650
www.theelgroup.com



WD
Engineering
410 ASBURY STREET
HOUSTON, TEXAS 77007
713.301.4922 OFFICE
WDENGINEERING.COM

FORT BEND COUNTY ENGINEER

ENGINEER: _____
J. Stacy Slawinski, P.E.

DATE: _____

THESE SIGNATURES ARE VOID IF CONSTRUCTION HAS NOT COMMENCED IN (1) YEAR FROM DATE OF APPROVAL.

APPROVED: _____
Development Staff

DATE: _____